



Dimensional Control

Culhig Surveying

Dimensional control is essentially the accurate measurement of 3D spaces or objects. It enables us to digitise, model and analyse the area or item surveyed and compare it to another object or its own design.

A concept originating in the offshore petroleum industry, dimensional control is now also used onshore across an array of disciplines, including the marine and aeronautical industries, as well as the mining, engineering and manufacturing sectors.

Applications

- 3D data capture
- Clash detection
- Equipment alignment
- Equipment fabrication
- Structural monitoring

Benefits

- Safety
- Re-work prevention
- Reduce installation times
- Eliminate clashing
- Minimise hotworks
- Reduce wear and tear

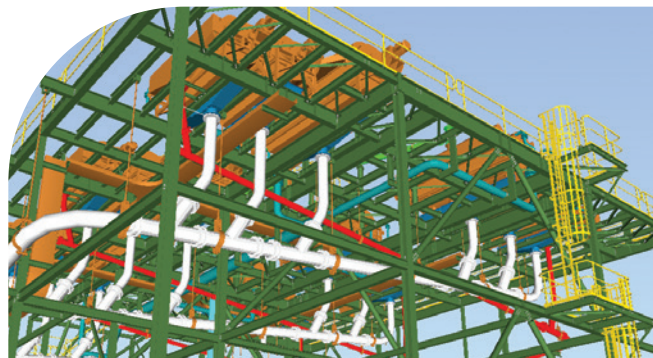

Structural, Mechanical and Piping Render



Survey Methodology

Infrared Laser:

- No access ladders, working at heights or scaffolding required
- Ability to survey in the most congested areas accurately

Laser Scanning:

- Point cloud data exportable directly to most design softwares
- Highly detailed models

Leica Truview

- Web based system to view data in real-time
- Mark up scans, check coordinates, take measurements and submit while still on site
- View the space or object without having to mobilise to site
- All required data is captured before departing the platform or site
- Complementary service



Leica Truview - Screenshot



LET'S TALK ABOUT YOUR NEXT PROJECT

Contact us **M** 0419 891 379 **E** admin.culhig.net.au



To find out more please visit www.culhigsurveying.net.au